

63015

Automatic Water Timer

User Instructions n English

63015_INS_ENG_01

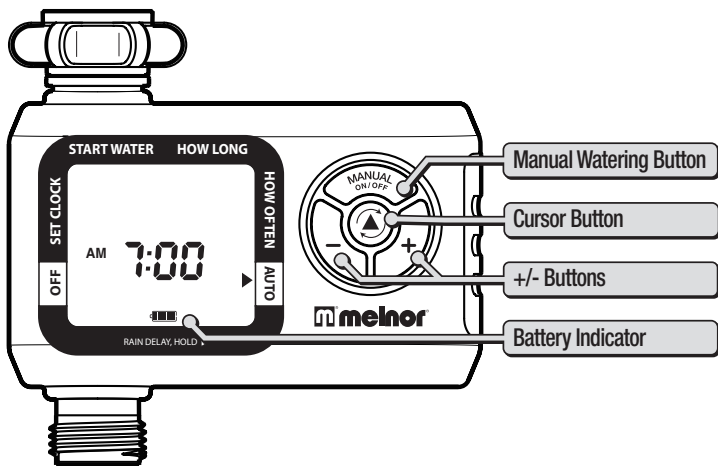

1 Battery Installation & Assembly

- Remove the battery holder from the back of the Timer Control Unit. Insert two AA alkaline batteries (Do not use rechargeable batteries) as indicated on the battery holder. Replace the battery holder, making sure that it is firmly and securely placed in the Timer Control Unit.
- NOTE: Do not use your timer when the air temperature is below 40°F (4.5° C). When storing your timer, be sure it is in a dry place and protected from frost.



We recommend replacing batteries when the indicator reaches



Installation of the Timer

- Attach the timer to an outside faucet and turn on the water. The water must be left on while the timer is attached to the faucet for your timer to operate.
- NOTE: You may choose to program your timer before or after attaching it to the faucet.

2 SETTING THE CLOCK

- Touch any button to wake the timer.
- Using the button, move the arrow to SET CLOCK.
- Press the & buttons to adjust the clock to the current time.
- Press the button again to set the time and move to the next setting, START WATER.



3 SELECT WHEN TO WATER

- With the arrow pointing to START WATER, use the & buttons to select the first time of the day you want to water. All remaining watering cycles during the day will be based on this time.
- Press the button to move to the next setting.



4 SELECT HOW LONG TO WATER

- With the arrow pointing to HOW LONG, use the & buttons to select the length of each watering cycle.
- Cycles can be up to 360 minutes (6 hours) in duration.
- Press the button to move to the next setting.



5 SELECT HOW OFTEN TO WATER

- With the arrow pointing to HOW OFTEN, use the & buttons to select the watering frequency.
- Watering can be as often as Every 1 Hours or little as Every 7 Days (once per week)
- Press the button to complete programming.
- The timer will enter AUTO mode and the program will be active. Watering will begin with the next available watering time.

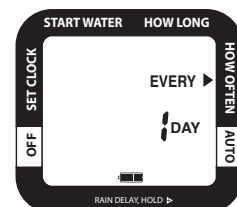



EVERY 1 DAY		SUNDAY	MONDAY	TUESDAY	WEDNESDAY	THURSDAY	FRIDAY	SATURDAY
EVERY WEEK		●	●	●	●	●	●	●
EVERY 2 DAY		SUNDAY	MONDAY	TUESDAY	WEDNESDAY	THURSDAY	FRIDAY	SATURDAY
WEEK ONE			●		●		●	
WEEK TWO		●				●		●
EVERY 3 DAY		SUNDAY	MONDAY	TUESDAY	WEDNESDAY	THURSDAY	FRIDAY	SATURDAY
WEEK ONE			●			●		
WEEK TWO		●			●			●

6 AUTO MODE

- After programming, the timer will be in AUTO mode.
- The screen display will toggle between the current TIME and the NEXT START TIME. This will allow you to see at a glance what will happen next.
- If the next watering cycle is more than 24 hours away, the NEXT START TIME will be displayed in days instead showing a time.



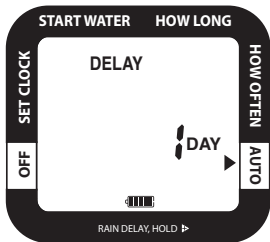

7 RAIN DELAY MODE

- If there is rain in the forecast and you wish to temporarily stop watering, you can use RAIN DELAY.
- RAIN DELAY mode will stop all watering for up to 7 days.
- After the delay period, the watering program will begin running automatically.
- To activate RAIN DELAY mode, make certain the arrow is pointing to AUTO. Press the  key to select the delay period. You can reduce the delay period with the  key.
- In RAIN DELAY mode, the screen will toggle between the current TIME and the remaining DELAY time. If the delay is greater than 12 hours, the DELAY will be shown in DAYS.





8 OFF MODE

- If you wish to stop watering for an extended period, push the  button until the arrow is pointing to OFF.
- The timer will not water automatically while in this mode. The screen will display the word OFF in large letters.
- To start watering automatically again, simply press the  button until the arrow is pointing to AUTO. The program will begin watering at the next available Start Time.



9 MANUAL WATERING

- To use a hose or other watering tool, simply press the  button. Then, using the  button, select the length of time you wish to water. After a few seconds, the valve will open, and then automatically close when the selected time is reached.
- To quit the manual function, press the  button again.
- Note: The timer will hold the last manual time in its memory. To reset the manual time back to zero, press the arrow keys to adjust the time.



10 TIMER RESET

- If you need to completely erase all settings in the timer and return it to its original state, press and hold the  button for 7 seconds.
- The screen will display RESET.
- NOTE: All programming will be lost when the timer is RESET.

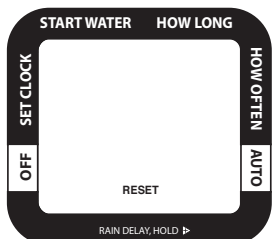

USEFUL TIPS

Open Valve During Installation

Shaking during transportation can cause valve to be open. If this occurs, water may run continuously through the valve during installation.

- Turn the water off.
- Remove the batteries. Wait for the screen to go blank. Reinsert the batteries.
- Note: Removing the batteries will not erase any existing watering schedules.
- Turn the water back on.
- If the problem persists, turn off the water. Use the Manual feature to open and close the valve 3 times.

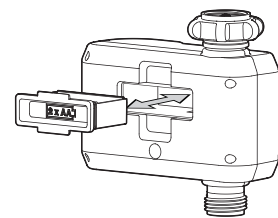

Cleaning Your Timer

You should clean your timer periodically. Debris or sediments commonly found in water can build up in your timer.

- Turn off the water. Remove the timer from the faucet and check that the filter washer is clear. If you notice any debris, remove the filter washer and

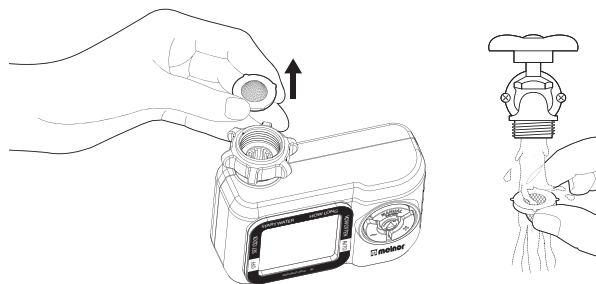

clean it out with water.

- Activate the MANUAL mode by pressing the MANUAL button. Open the valve and spray water through the valve and the faucet connection to flush out any built-up sediments or debris.

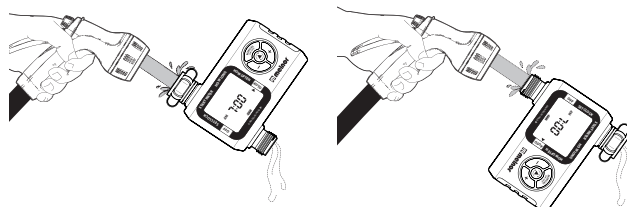

Seasonal Storage

Freezing temperatures can cause water in the timer to freeze and expand, damaging the timer.

- At the end of the season or when there is frost in the forecast, turn off the water and remove your timer from the faucet.
- Remove the batteries.
- Be sure to store the timer indoors, away from freezing temperatures.

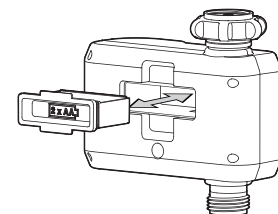

Tips for Battery Life

- Make sure to use fresh alkaline batteries.
- Do not use rechargeable batteries.
- Remove the batteries at the end of the season before storing.
- Batteries should last about one season. A schedule with more frequent watering times can cause the batteries to drain faster.



Warning: Intended for outdoor use only. Severe electrical shock could result if water is sprayed into outlets or sources of electrical current. Do not use water more than 115°F (46°C). Do not use when the ambient air temperature is less 40°F (4.5°C). When not in use, remove batteries, drain and store indoors away from freezing temperatures.